

2

MONTAGEANLEITUNG INSTALLATION INSTRUCTION

AUSSENBLLENDE

DE

OUTSIDE COVER

EN

LIEFERUMFANG SCOPE OF DELIVERY

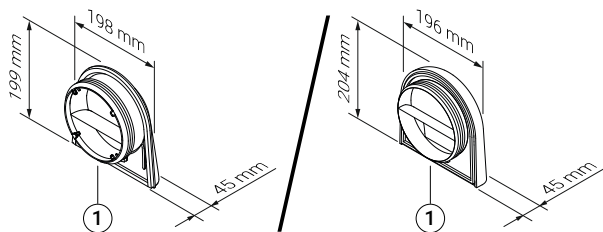







1x Außenblende Smart / Außenblende easy
Outside Cover Smart / Outside cover easy

Technische Änderungen vorbehalten. Aktueller Stand ist auf der Hersteller-Homepage zu finden.
Technical changes reserved. For current status see manufacturer's homepage.

201209-01 54109110

SYMBOLERKLÄRUNG

EXPLANATION OF SYMBOLS

	Innenansicht Interior view		Außenansicht Exterior view
	Richtig Right		Falsch Wrong
	Montageanleitung Installation instruction		Bedienungsanleitung Operating instruction
	Beachten Note		

MONTAGE

INSTALLATION

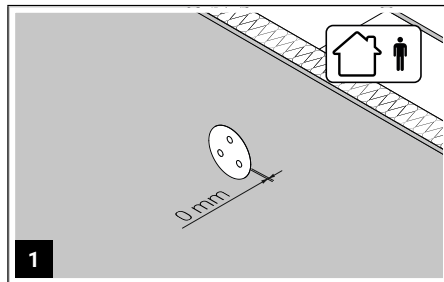

Das Montagerohr ist installiert und bündig mit der Wand. Die Fassadenarbeiten sind abgeschlossen.

The mounting tube is installed and flush with the wall. The facade work is completed.

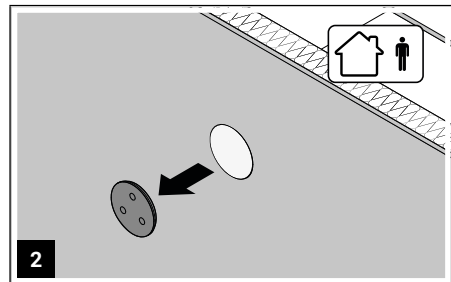

Den Putzdeckel außen abnehmen und das Montagerohr von überstehenden Putzresten befreien.

Remove the outer plaster cover and free the mounting tube from overhanging plaster residue.

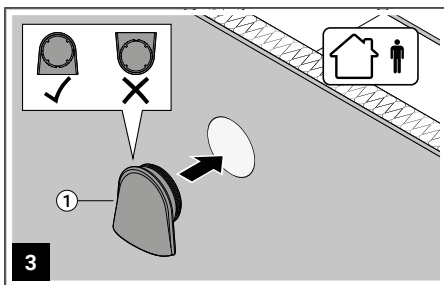

Außenblende mit der Öffnung nach unten wandbündig ins Montagerohr stecken.

Insert the outside cover flush with the wall into the mounting tube so that the outlet faces downwards.

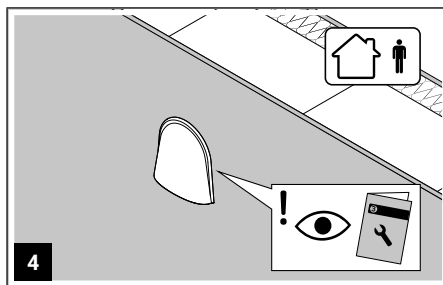

Nach Abschließen der Innenarbeiten kann die Funktionseinheit installiert werden. Weitere Installationsanweisungen liegen dieser bei.

After the interior work, the functional unit can be installed. Further installation instructions are enclosed.

